

WHISKY CX FORK INSTRUCTIONS



▲ WARNING: CYCLING CAN BE DANGEROUS. BICYCLE PRODUCTS SHOULD BE INSTALLED AND SERVICED BY A PROFESSIONAL MECHANIC. NEVER MODIFY YOUR BICYCLE OR ACCESSORIES. READ AND FOLLOW ALL PRODUCT INSTRUCTIONS AND WARNINGS INCLUDING INFORMATION ON THE MANUFACTURER'S WEBSITE. INSPECT YOUR BICYCLE BEFORE EVERY RIDE. ALWAYS WEAR A HELMET.

Additional safety info can be found at: whiskyparts.com/safety

Intended Use & Compatibility



Whisky CX forks are available in a variety of steerer tube, axle, and brake configurations to work with your cyclocross bicycle. Consult with a professional bicycle mechanic to ensure that your new Whisky Parts Co fork is compatible with your cyclocross bicycle.

ASTM Condition 2: For use on paved, unpaved, and gravel roads and trails with moderate grades. Contact with irregular terrain and loss of tire contact with the ground may occur. Drops are intended to be limited to 15cm (6") or less.

IMPORTANT NOTE: Whisky Parts Co. recommends no less than 6mm of clearance between the tire, wheel, fork and frame.

Tools Required

- Hacksaw with a fine 32 tpi tungsten carbide steel blade
- Steerer tube cutting guide (recommended)
- Allen wrenches: 4, 5, 6mm
- Torque wrench that measures in Newton meters
- 8mm box end wrench
- Blue threadlocker

Stem & Headset Preparation

1. Verify that the fork, headset and all parts required for proper assembly have compatible dimensions. The fork, headset, headset spacers, and stem steerer clamp must have compatible diameters.

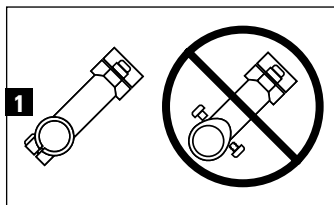

Incorrect use of components can cause component failure. Visit headsetfinder.com

to verify fork-to-frame compatibility options. Visit bicycleheadsets.com to learn more about headset fit and the new Standardized Headset Identification System (SHIS).

2. Make sure any stem or headset parts that come into contact with the steerer tube are free of burrs or sharp edges. Remove burrs or sharp edges with fine-grit sandpaper.
3. Only use rear slot-style clamping stems on carbon steerers. Wedge-clamp stems must not be used and could result in failure (figure 1).

Fork Preparation

1. Install crown race according to manufacturer's instructions. Do not place the fork on the dropout tips or crown while installing the race. Doing so can damage the fork and could cause failure (figure 2).
2. Assemble the fork, headset and any spacers in the headtube of the bicycle and install the stem (figure 3).
3. The spacer stack between the headset and stem must not exceed 50mm (figure 4).
4. A steerer tube must extend 7–8mm above the top of the stem clamp and have a 10mm spacer installed between the stem and top cap (figure 4).
5. Carefully measure and mark the amount of steerer tube to be removed. Remember that, when cut, the top of the steerer tube must be 2–3mm below the top of the headset spacer/stem assembly (figure 5).
6. Remove the fork from the headtube.
7. Make certain that you do not cut the steerer tube too short—measure twice, cut once.

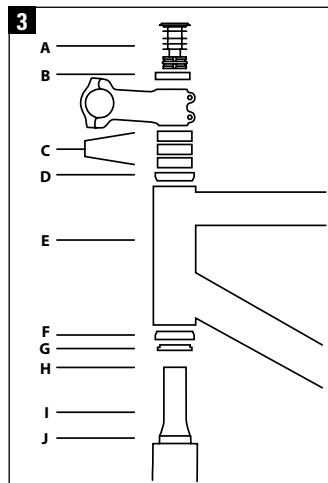
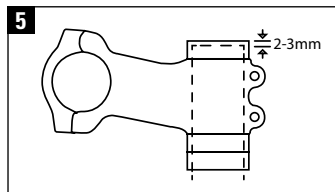
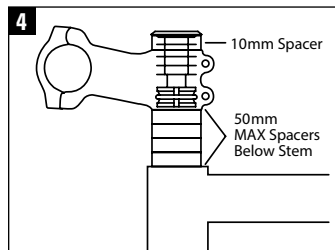
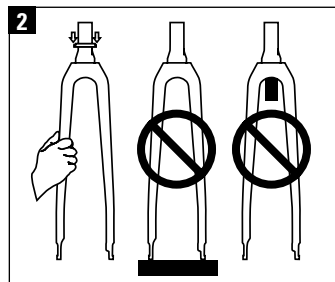

- A Compression device
- B 10mm spacer
- C Spacers (50mm max)
- D Upper headset
- E Headtube
- F Lower headset
- G Fork crown race
- H Top of steerer tube
- I Fork steerer tube
- J Crown race seat

Carbon Steerer Cutting

1. Cut the steerer tube using a hacksaw with a fresh 32 tpi tungsten carbide steel blade, and cutting guide.
2. Remove burrs and sharp edges with a synthetic scouring pad.
3. Clean the steerer tube and inside of the stem clamp using rubbing alcohol to remove any grease and dirt.

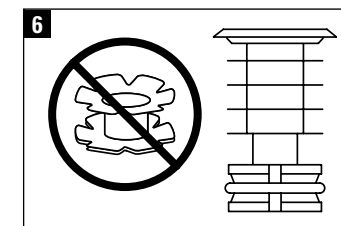

▲ WARNING: Never use a star nut with a carbon steerer tube fork (figure 6). Star nuts can only be used with aluminum steerer tube forks. Use only a compression device designed for carbon steerers.

Fork Installation

1. Install spacers, stem, etc. and tighten compression plug (if applicable) to 1.6Nm (15 in-lb).
2. Insert top cap and tighten to headset/top cap manufacturer's recommend torque specifications.
3. Tighten stem steerer clamp bolts to stem manufacturer's recommended torque specifications.
4. Install and adjust the front brake following the brake manufacturer's instructions.

▲ WARNING: Failure to properly install and adjust brakes can result in serious injury.

▲ WARNING: Failure to properly adjust the quick release or thru-axle to secure the wheel can result in serious injury.

Fender Installation

(for forks equipped with removable fender mounts)

▲ WARNING: To avoid potential serious injury, Whisky recommends that its forks be used solely with ISO-approved quick-release fenders. Consult fender manufacturer for specific compatibility.

▲ WARNING: Do not mount racks or any other load bearing accessory to the fender mounts. Doing so could result in fork breakage, causing a loss of control.

1. Remove set screws from fender mounting holes.
2. Apply Blue threadlocker onto bolts.
3. Thread M5 nuts onto bolts.
4. Make sure the nuts are threaded into the bolts at least 6 to 7 threads.
5. Thread bolts into fork leg fender-mounting holes.
6. Make sure fender mounts are threaded in at least 4 threads.
7. Thread nut up to the fork leg.
8. Make sure fender mount face is parallel with plane of frame and fork.
9. Tighten nut to 3–4Nm to lock fender mount into position.

10. Check that assembly is properly tight.
11. Install fenders per fender manufacturer's specifications.
NOTE: Whisky recommends breakaway fenders only!
12. An M5 screw will need to be used to mount fender crown hardware to fork.

Ongoing Maintenance

Periodically check to make sure all mounting bolts are properly tightened to the frame, and that the fenders are properly tightened and installed per the fender manufacturer's specifications.

Fork-Mount Bicycle Racks

1. When using a fork-mount (axle dropout-clamping) bicycle rack, always ensure the clamp is closed securely to prevent dropout and/or bike damage. If the clamp is set too loosely the bike can fall out of the rack.
2. When removing the fork from the clamping device make sure to pull/push straight up allowing the dropouts to be removed evenly and at the same time. Do not tilt the bike to remove it from the clamping device, as dropout damage can result (figure 7).

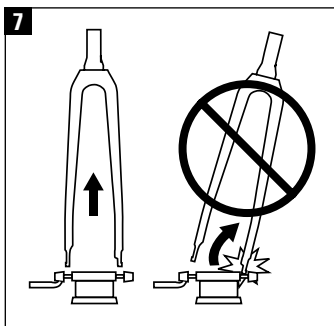

⚠ WARNING: Dropout damage can cause component failure, which can result in serious injury.

Ongoing Maintenance

⚠ WARNING: Do not modify the fork, other than cutting the steerer tube to the correct length for your bicycle. Modifying the fork could cause fork or other component failure resulting in serious injury.

1. Loosen the stem's steerer clamp bolts before making any stem-to-fork alignment adjustments.
2. Periodically remove, clean, and inspect your fork for damage, cracks, or any other signs of premature wear. Any questions about marks or cracks on the fork should be directed to your Whisky Parts Co. dealer immediately.

3. In the event of a crash or impact, carefully inspect handlebars, fork, stem, seatpost, wheels, and the frame for any visible damage. As with any component under varying degrees of stress there is a fatigue life that is proportional to the type of use and abuse applied to the part. Always inspect your components before a ride. If you have doubts about the integrity and condition of any part, replace it. Consult your dealer if you are unsure about the condition of your components or any part of your bicycle.

Warranty Registration:

Proof of purchase is required before a warranty claim is processed. Whisky Parts Co. therefore strongly encourages warranty registration at whiskyparts.com. Failure to register will not affect consumer rights under the limited warranty, so long as the consumer can show in a reasonable manner proof of original ownership and the date the Whisky Parts Co. product was purchased.

If you have any questions contact warranty@whiskyparts.com.